

TECHNICAL DESCRIPTION



Multi Cutter GB

MULTI CUTTER GB

The tool is adjusted to regenerate the left chassis of the level run in a few types of automatic as well as mechanic gearboxes used, e.g. in Audi cars.

Selected types of gearboxes are:

0AW- Multitronic 8 gears automatic

0B5- S-tronic 7 gears automatic

Short operation description.

Tools are mounted with three screws to gearbox block located where the axis coming out of differential gear on the left side of the housing. When all mounting screws are tightened the tool is automatically positioned in the right place, which means perpendicularly centralised in relation to mechanism axis. Next, when tubular spanner is mounted and a special connector is added (1) and the proper drill was applied, it is possible to perform cutting treatment of the bearing seating. These actions can be performed in a short time on a dismounted gear as well as one mounted in a car upon application of standard pipe extension from the set of tubular spanner and disassembly of a wheel and a few other elements. **A possibility of performance of these works without a necessity of disassembly of the gearbox significantly reduces the working time and highly reduces costs.**

Construction description

Multi Cutter GB consists of a head, including three interchangeable blades, it is permanently connected with a long guiding pin, located in a socket made of anti-friction material, allowing to achieve extremely high quality of a treaded hole. Next, the tool is mounted in the self-centralising housing due to three holes placed on the borders. It can be made of aluminium, steel as well as other materials. On the opposite side of the head, there was mounted a pin in the shape of a disc in order to facilitate operation. This handle is mounted in the distant socket and level run based with a steel element on the other side, protected with a Seeger ring.

The summary of main elements on the basis of a drawing:

1-connector

2-tubular spanner

3-tip of pin in the shape of hexagon

4-bearing support

5-mobile pin in the disc shape

6-guiding pin

7-housing

8,9,10-centering-mounting holes

11-head

12-one of three interchangeable blades

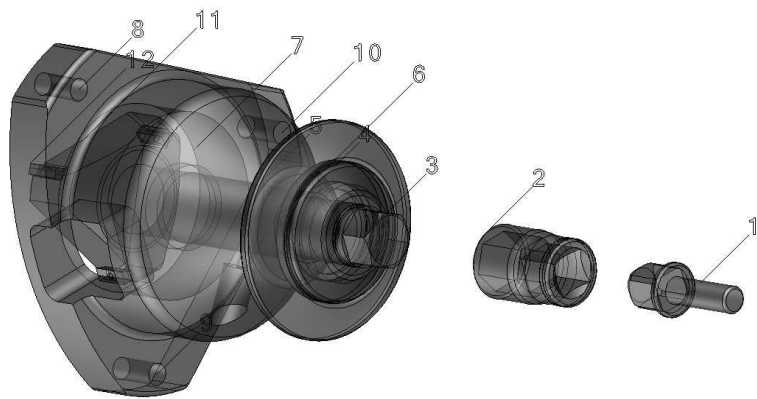
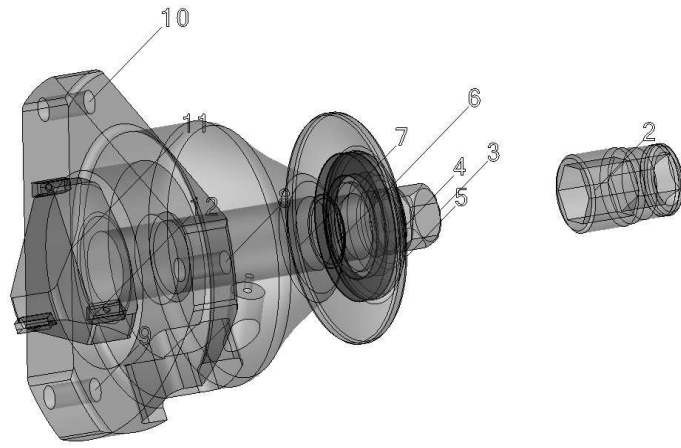

Additional information

Between elements 3 and 4 there is a Seeger ring, a bearing with 4 or 5 elements, whereas, in the main pin disc there is a distant elemental mounted, setting clearance between 6th pin and 5th disc , limiting the speed of a treated bearing seat. In the main 7th part there was placed a socket made of metal resistant to excessive friction, at which a head pin works in rotatory and linear movement. Additionally, in the external 7th part **there are placed two holes, one larger in the square shape in order to carry away the chips and increasing round hole with the aim of periodical discharge of lubricating oil.**

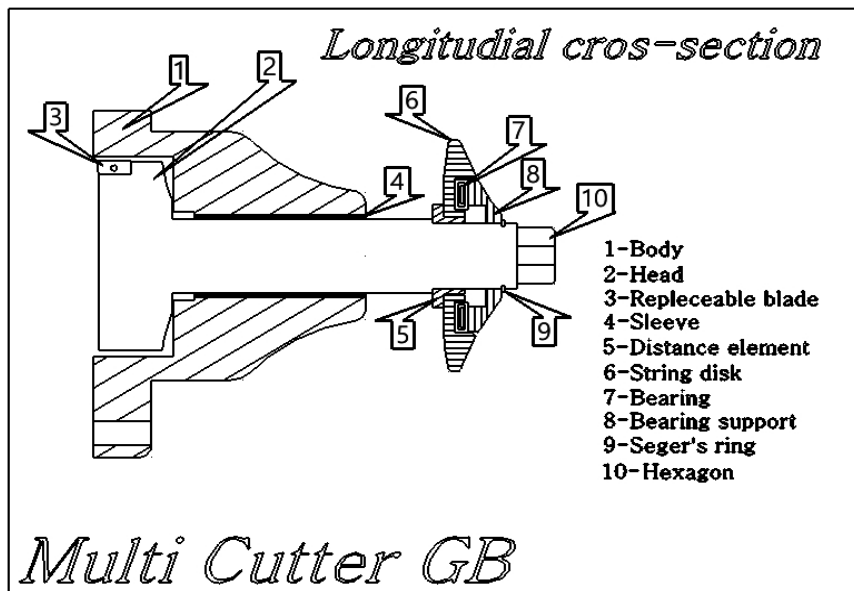
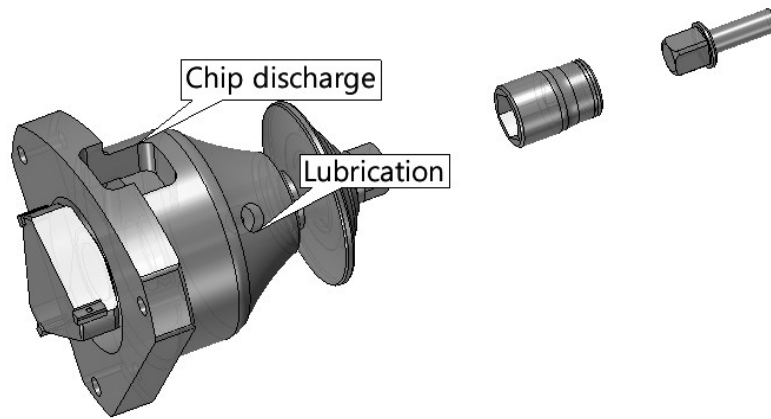

GUARANTEE CONDITIONS

Multi Cutter GB

Multi Cutter GB producer grants guarantee of satisfaction of fool-proof operation of the tool for a period of one year. Concurrently, he reserves the right that all faults that arise due to hitting, collapse or other operation inconsistent with the manual and corrosion should not be subject of the guarantee.

Guarantee also does not cover:

- 1-Interchangeable plates (blades)
- 2-Mounting screws of the interchangeable blades
- 3-T8 spanner
- 4-Oiler



Indications and limits

1-a tubular spanner must always be used with *Multi Cutter GB* (technical description no. 2) of a hexagonal type.

2-Maximum rotation of cutter head is 3000 RPM during five minutes of continuous work.

3-head pin must be lubricated prior to every operation.

*Project, construction and
operation manual and technical
description*

Grzegorz Brzezowski

Multi Cutter GB is a tool produced in cooperation with
ASGB Automatic Service (Poland)
and AutoGB (France)

www.sppeyer.com